

NOTES:

- A. PROTECT THE PREPRUFE FLAP FROM DAMAGE AND OVERSPLASH DURING CONCRETE PLACEMENT
- B. INSTALL SILCOR WATERPROOFING SYSTEM FOLLOWING ALL PROPER INSTALLATION PROCEDURES
- C. INSTALL A MIN. OF 90-MILS, 2.5 mm BITUTHENE LIQUID MEMBRANE (LM) OVER SILCOR AS SHOWN
- D. INSTALL A FILLET OF BITUTHENE LIQUID MEMBRANE AGAINST THE PREPRUFE FLAP PRIOR TO EMBEDDING THE FLAP INTO THE UNCURED (i.e. WET) LM (SEE NEXT DRAWING FOR ADDITIONAL DETAILING INSTRUCTIONS)
- E. MAKE RELIEF CUTS AS NECESSARY IN THE PREPRUFE FLAP, ENSURING ANY RELIEF CUTS ARE A MIN. OF 1 in, 25 mm FROM THE FOLD, ALL RELIEF CUTS MUST BE SEALED WITH LM EXTENDING PAST THE CUT 3 in, 75 mm IN ALL DIRECTIONS
- F. INSTALL TERMINATION BAR SEALED WITH LM AND ADD SAND BAGS AS BALLAST ONTO THE PREPRUFE FLAP, ONCE THE LM HAS FULLY CURED, REMOVE BALLAST
- G. INSTALL BITUTHENE MEMBRANE AND SEAL ALL EDGES, CUTS AND LAPS A MINIMUM OF 18 in, 450 mm FROM THE PERIMETER WITH LM
- H. HYDRODUCT 660 (OPTIONAL) NOT SHOWN FOR CLARITY
- I. GCP MAY REQUIRE ALTERNATE GCP WATERSTOP BASED ON DESIGN CONDITIONS



**PREPRUFE® WATERPROOFING SYSTEM**  
**TIE-IN TO SILCOR® (INACCESSABLE -1 of 2)**  
**PRIOR REVIEW AND APPROVAL REQUIRED**

Drawing: SIL-05042017-1

Scale: Not to Scale

Effective Date: 05/04/17

Supersedes: NEW

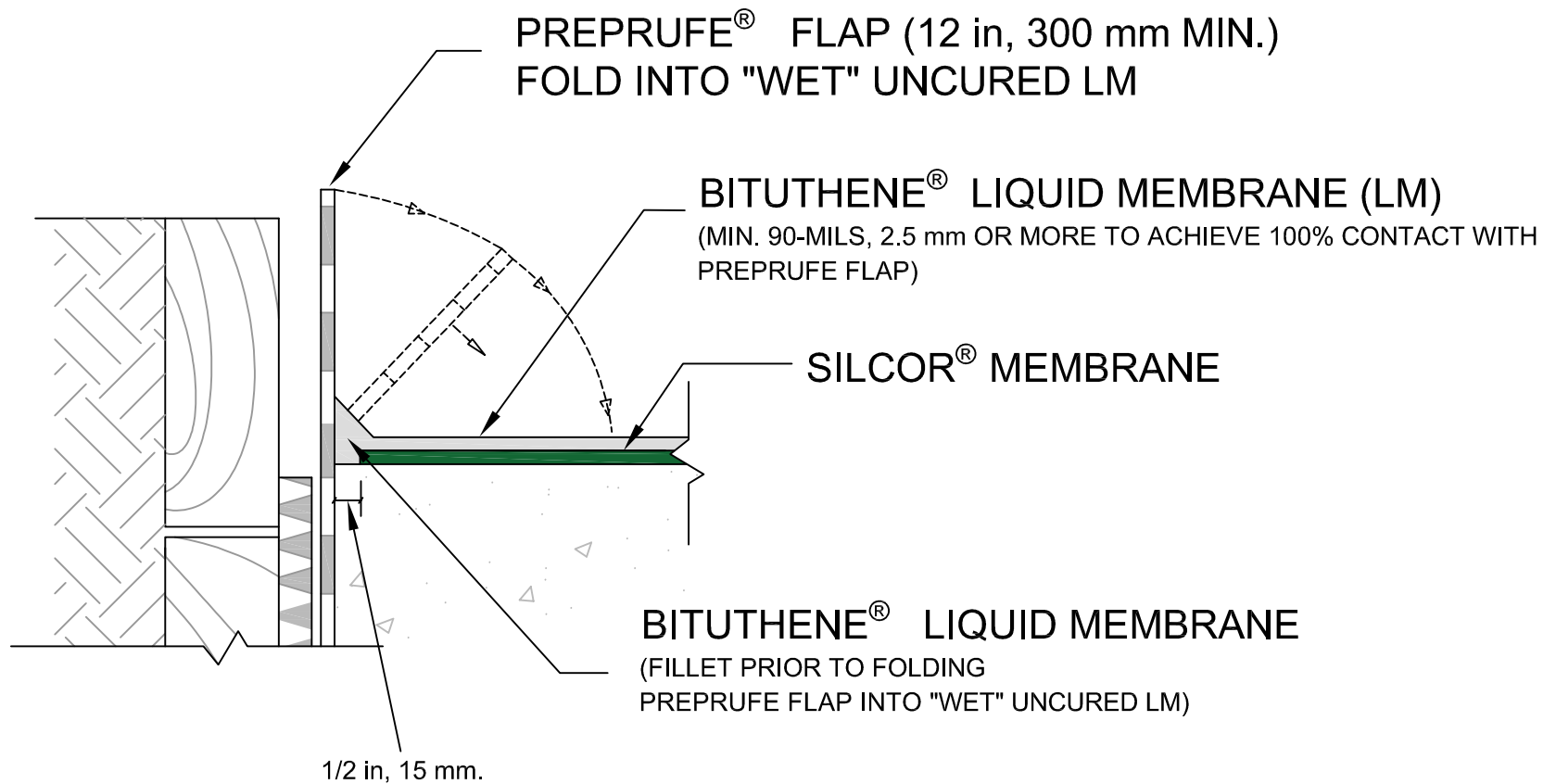

NOTES:

- A. PROTECT THE PREPRUFE FLAP FROM DAMAGE AND OVSPLASH DURING CONCRETE PLACEMENT
- B. INSTALL SILCOR WATERPROOFING SYSTEM FOLLOWING ALL PROPER INSTALLATION PROCEDURES
- C. INSTALL A MIN. OF 90-MILS, 2.5 mm BITUTHENE LIQUID MEMBRANE (LM) OVER SILCOR AS SHOWN
- D. INSTALL A FILLET OF BITUTHENE LIQUID MEMBRANE AGAINST THE PREPRUFE FLAP PRIOR EMBEDDING THE FLAP INTO THE UNCURED (i.e. WET) LM
- E. MAKE RELIEF CUTS AS NECESSARY IN THE PREPRUFE FLAP, ENSURING ANY RELIEF CUTS ARE A MIN. OF 1 in, 25 mm FROM THE FOLD, ALL RELIEF CUTS MUST BE SEALED WITH LM EXTENDING PAST THE CUT 3 in, 75 mm IN ALL DIRECTIONS
- F. INSTALL TERMINATION BAR SEALED WITH LM AND ADD SAND BAGS AS BALLAST ONTO THE PREPRUFE FLAP, ONCE THE LM HAS FULLY CURED, REMOVE BALLAST
- G. SEE DRAWING SIL-0504201-1 FOR ADDITIONAL DETAILING INSTRUCTIONS



**PREPRUFE® WATERPROOFING SYSTEM  
TIE-IN TO SILCOR® (INACCESSABLE -2 of 2)  
PRIOR REVIEW AND APPROVAL REQUIRED**

Drawing: SIL-05042017-2

Scale: Not to Scale

Effective Date: 05/04/2017

Supersedes: NEW