

# BITUTHENE<sup>®</sup> Liquid Membrane

Two component, elastomeric, liquid applied detailing compound for use with GCP waterproofing membranes

---

## Product Description

Bituthene<sup>®</sup>Liquid Membrane is a two component, elastomeric, cold applied, trowel grade material designed for a variety of uses with the GCP waterproofing systems. The VOC (Volatile Organic Compound) content is 10 g/L. Architectural and industrial maintenance regulations limit the VOC content in products classified as architectural coatings. Refer to Technical Letters for the most current list of allowable limits.

## Use

Bituthene<sup>®</sup>Liquid Membrane is ideally suited for the following uses:

- Fillet material at inside corners
- Reinforcement material at inside corners
- Flashing material around drains, protrusions, curbs and parapets
- Sealing material at terminations
- Repair material for defects on concrete surfaces
- Flashing material at corners

The two parts of Bituthene<sup>®</sup>Liquid Membrane are mixed on site and troweled on to provide a simple and quick waterproofing detailing aid in conjunction with Bituthene<sup>®</sup>, Preprufe<sup>®</sup>and Procor<sup>®</sup>systems.

## Product Advantages

- Liquid applied
- Waterproof
- Tough, rubber-like
- Chemically cured
- Cold applied
- System compatible

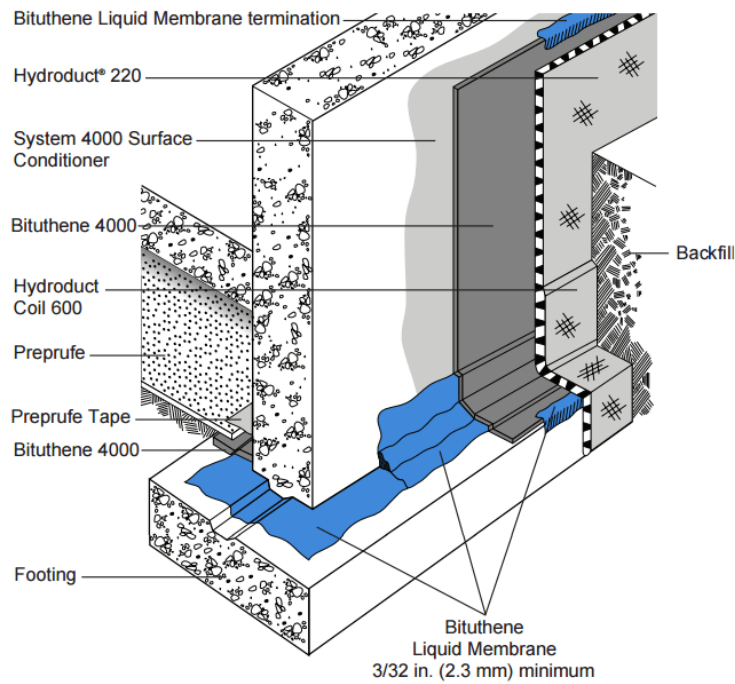

## Supply

BITUTHENE® LIQUID MEMBRANE PROPERTY	PART A VALUE	PART B VALUE
Unit size	1.5 gal (5.7 L)	4 gal (15.1 L)
Net weight per unit	12.4 lbs (5.6 kg)	33 lbs (15 kg)
Units per pallet	100	24

## Surface Preparation

All surfaces must be dry and free from dirt, grease, oil, dust or other contaminants. Bituthene®Liquid Membrane may be applied at temperatures of 25 °F (-4 °C) or above. Store in a dry place above 40 °F.

## Mixing

Add the entire contents of the Part B container to Part A and mix for 3 to 5 minutes until uniform. Part A is black and Part B is clear. Take care to scrape material from the side and bottom of the containers to ensure thorough mixing. A low speed (150 rpm) mechanical mixer with flat paddle blades is required. Do not apply any material if streaks can be seen due to insufficient mixing. Once mixed, Bituthene®Liquid Membrane must be applied by trowel within 1.5 hours. More time is available at lower temperatures.

At high temperatures, thickening and curing will be faster. Material that has thickened must be discarded. The material will cure to a very flexible rubber-like material.

Bituthene®Liquid Membrane must be applied at a minimum thickness of 3/16 in. (2.3 mm) unless otherwise noted on details. In fillet applications, the face of the fillet should be a minimum of 3/4 in. (20 mm). In corner flashing application details, it should extend 6 in. (150 mm) in each direction from the corner. Bituthene®Liquid Membrane will adhere to primed or unprimed concrete.

Bituthene®Liquid Membrane should be allowed to cure at least 24 hours before flood testing.

## Coverage

As a fillet material, 1 gal (3.8 L) will cover approximately 100 linear feet (30 m). As a flashing material, 1 gal (3.8 L) will cover approximately 17 f<sup>2</sup> (1.6 m<sup>2</sup>). As a fillet and reinforcement, 1 gal (3.8 L) will cover approximately 14 linear feet (4.3 m).

## Cleaning

Clean tools and equipment with mineral spirits before Bituthene®Liquid Membrane has cured. Mineral spirits is a combustible liquid and should be used only in accordance with the manufacturer's safety recommendations. Do not use solvents to clean hands or skin.

## Application Procedures

### Safety, Storage and Handling Information

Bituthene®products must be handled properly. Vapors from solventbased primers and mastic are harmful and flammable. For these products, the best available information on safe handling, storage, personal protection, health and environmental considerations has been gathered. Safety Data Sheets (SDS) are available at [gcpat.com](http://gcpat.com) and users should acquaint themselves with this information. Carefully read detailed precaution statements on product labels and the SDS before use.

## Physical Properties

PROPERTY	TYPICAL VALUE	TEST METHOD
Part A Color	Black	
Part B Color	Clear	
Mixture of Parts A and B Color	Black	
Solids content	100%	ASTM D1644
Elongation	250% minimum	ASTM D412
Peel strength	5 lbs/in. (880 N/m) minimum	ASTM D903
Flexibility, 180° bend over 1 in. (25 mm) mandrel at -25°F (-32°C)	Unaffected	ASTM D1970

[gcpat.com](http://gcpat.com) | North America customer service: 1-866-333-3726

We hope the information here will be helpful. It is based on data and knowledge considered to be true and accurate, and is offered for consideration, investigation and verification by the user, but we do not warrant the results to be obtained. Please read all statements, recommendations, and suggestions in conjunction with our conditions of sale, which apply to all goods supplied by us. No statement, recommendation, or suggestion is intended for any use that would infringe any patent, copyright, or other third party right.

Bituthene, Procor and Preprufe are trademarks, which may be registered in the United States and/or other countries, of GCP Applied Technologies Inc. This trademark list has been compiled using available published information as of the publication date and may not accurately reflect current trademark ownership or status.

© Copyright 2018 GCP Applied Technologies Inc. All rights reserved.

GCP Applied Technologies Inc., 62 Whittemore Avenue, Cambridge, MA 02140 USA.

In Canada, GCP 294 Clements Road, West, Ajax, Ontario, Canada L1S 3C6.

Ce document est à jour seulement à la date de la dernière mise à jour indiquée ci-dessous et n'est valide que pour une utilisation au Canada. Il est important que vous consultiez toujours les informations actuellement disponibles sur l'URL ci-dessous pour fournir les informations les plus récentes sur le produit au moment de l'utilisation. Des documents supplémentaires tels que les manuels de l'entrepreneur, les bulletins techniques, les dessins détaillés et les recommandations détaillées ainsi que d'autres documents pertinents sont également disponibles sur [www.ca.gcpat.com](http://www.ca.gcpat.com). Les informations trouvées sur d'autres sites Web ne doivent pas être utilisées, car elles peuvent ne pas être à jour ou applicables aux conditions de votre site et nous déclinons toute responsabilité quant à leur contenu. S'il y a des conflits ou si vous avez besoin de plus d'informations, veuillez contacter le service client de GCP.

Last Updated: 2019-05-30

[ca.gcpat.com/solutions/products/bituthene-post-applied-waterproofing-liquid-membrane](http://ca.gcpat.com/solutions/products/bituthene-post-applied-waterproofing-liquid-membrane)