

BITUTHENE® MASTIC,
BITUTHENE® LIQUID
MEMBRANE, OR
TERMINATION BAR

USE BITUTHENE® LIQUID
MEMBRANE OR OTHER
SUITABLE MATERIAL TO
SMOOTH ROUGH VERTICAL
AREAS

ADCOR®
WATERSTOP

BITUTHENE® LIQUID
MEMBRANE FILLET

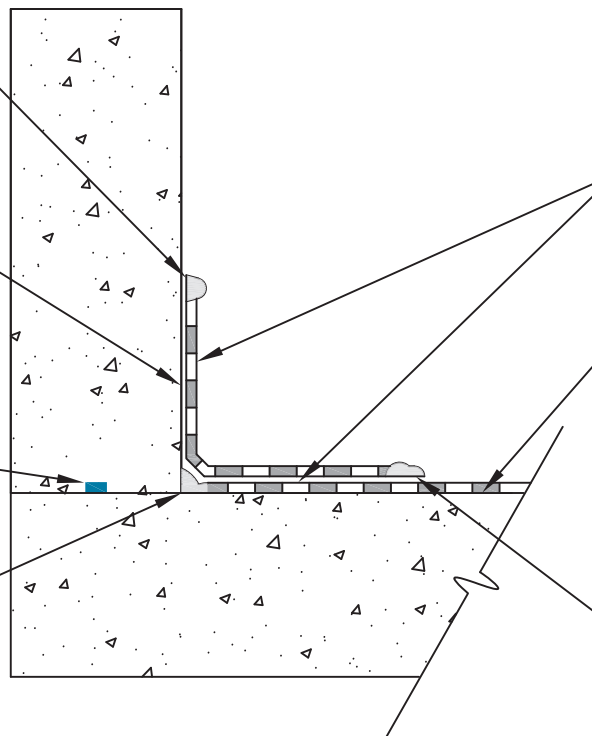

BITUTHENE® MEMBRANE

USE BITUTHENE® DECK PREP
SURFACE TREATMENT TO
SMOOTH ROUGH DECK AREAS

BITUTHENE® MASTIC OR
BITUTHENE® LIQUID MEMBRANE
ALL SEAMS WITHIN 12 IN.
(300 mm) OF CORNER

- NOTES
- HYDRODUCT OR APPROVED PROTECTION COURSE NOT SHOWN FOR CLARITY
 - GCP MAY REQUIRE AN ALTERNATE GCP WATERSTOP BASED ON DESIGN CONDITIONS



PLAZA DECK
DECK TO WALL INSIDE CORNER (OPTION 2)
BITUTHENE® WATERPROOFING SYSTEM

DRAWING: BIT-019

SCALE: Not to scale

EFFECTIVE DATE: 07/01/2016

SUPERCEDES: 04012015

Plaza Deck

Deck to Wall Inside Corner (Option 1)

Prior to Membrane Installation, Review the Bituthene®
Data Sheet



Surface Prep

All surfaces must be structurally sound and free from spalled areas, loose aggregate, sharp protrusions or other matter that may hinder the adhesion or regularity of the membrane installation. The surface should also be free from frost, dirt, grease, oil or other contaminants as outlined in the Bituthene® Data Sheet section on Surface Preparation. Clean loose dust and dirt from the surface and prime with appropriate primer.

Detailing

1. Apply Bituthene Deck Prep Surface Treatment on horizontal surface to smooth rough deck areas to prepare the surface to receive the Bituthene membrane.
2. Apply Bituthene Liquid Membrane or other suitable material to smooth rough vertical areas to prepare the surface to receive the Bituthene membrane.
3. Apply Bituthene membrane on the horizontal surface in accordance with the Bituthene Data Sheet section on Installation. Apply membrane to within 1 in (25 mm) of base of wall.
4. Install membrane from the low point to the high point so that laps shed water.
5. Apply Bituthene membrane on vertical wall to within 1 in (25 mm) of base of wall.
6. Apply Bituthene Liquid Membrane along inside corner, forming a 1-inch fillet, extending over the Bituthene membrane a minimum of 2.5 in (65 mm).
7. Apply bead of Bituthene Liquid Membrane or Mastic on all terminations and T-joints.

Special Notes

Bituthene membranes should not be used in areas where they will be permanently exposed to sunlight, weather or traffic. Protect membrane from sunlight as quickly as possible after installation.

Ensure Adcor® waterstop is encapsulated with 3 in (75 mm) of concrete cover minimum. Apply Adcor® waterstop to the installation instructions found on the data sheet.

GCP may require an alternative GCP waterstop based on design conditions, at GCP's discretion.