

SILCOR® PRIMER EPS

Two component, epoxy primer for use with Silcor® liquid waterproofing membranes for hot weather applications

Product Description

Silcor® Primer EPS is a two-component epoxy primer specifically formulated for application in hot weather conditions. Pot life and the reaction at 95°F is similar to the pot life and the recoat time of a standard epoxy primer at 68°F. All components are pre-weighted in an easy to mix system.

Principal Applications

- Epoxy primer for hot weather applications prior to the application of Silcor liquid waterproofing membranes.

Installation

1. Surface Preparation

- Minimum cohesive strength of concrete required is 115 psi for limited access roofs and 215 psi for vehicular trafficked decks. Where these values are not achieved by pull-off adhesion testing, remove all laitance by shot blasting.
- Surfaces must be clean, sound, free of dust, laitance, sealers, grease or any other contaminants that might reduce adhesion.
- If power washing the substrate, allow sufficient time for the residual humidity to dissipate. The substrate moisture content before application of the primer must be less than 5%. The primer surface before application of Silcor liquid membrane must be clean and dry.
- For further details concerning surface preparation guidelines and primer choice, refer to the Silcor Application Manual.

2. Mixing

- Store Silcor Primer EPS in a dry and cool place, out of direct sunlight.
- Add the complete B-component to the A-component to assure correct mixing ratio.
- Mix with a slow turning mixer (less than 300 rpm) for 3 minutes in order to obtain a homogenous mixture.

3. Application

- The substrate application temperature must be between 65°F and 105°F.
- Apply Silcor Primer EPS to the surface by brush or roller immediately after mixing ensuring coverage of the entire surface.

Product Advantages

- Adjusted pot life and curing for **hot weather applications**
- **Excellent adhesion:** exceeds concrete cohesive strength
- **Easy to use** multi-purpose primer
- **Easy to apply** by roller or brush

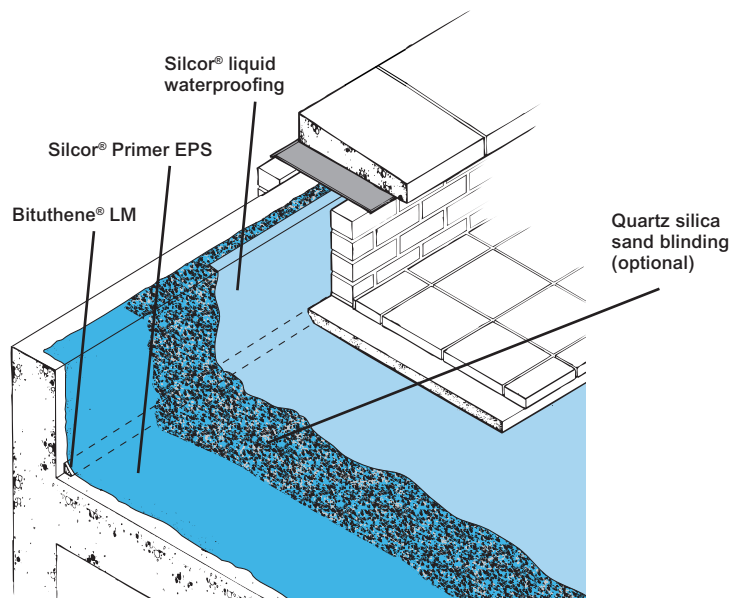

Details shown are typical illustrations only and not working drawings. For assistance with working drawings and additional technical advice please contact GCP Technical Services.

Supply

Approx. Unit Size	
Silcor Primer EPS Part A	1.5 gal
Silcor Primer EPS Part B	0.9 gal

Properties

Property	Typical Value
Adhesion to concrete	surpasses concrete coherence
Density	8.8 lbs/gal
Viscosity (mixture) at 95 °F	Approx. 500 cps
Pot Life (250 g) at 95 °F	Approx. 40 min
Touch dry time at 95 °F	Approx. 3 hours
Full cure	7 days
Minimum substrate application temperature	65 °F

- Pour the primer onto the surface in a zigzag trail.
- After pouring onto the surface, distribute the primer evenly with foam rubber squeegees and roll using Perlon rollers.
- The primer should be evenly distributed at 10 mils thickness with complete coverage of the surface.
- If the surface is very porous and absorbs primer to an extent that open surface remains, additional primer should be added in this area within the pot life or recoat time of the primer.

4. Curing

- The Silcor membrane should be applied within 24 hours. This window is influenced by ambient temperature and humidity. When this time is exceeded before the membrane is applied, re-apply a new layer of Silcor Primer EPS.
- The Silcor membrane application window using Silcor Primer EPS can be extended by broadcasting dry quartz silica sand into the primed surface. Broadcast sand to full saturation. Use sand of 16/30 mesh for coating thickness of up to 80 mils. For larger coating thicknesses larger grain sizes can be used. Remove surplus sand and partially bonded particles with a scrubber after the primer is dry to the touch.

- Silcor Primer EPS can be filled with dry quartz silica sand (20/40 mesh) to make a scratch coat for repairing and leveling small surface defects before the application of the membrane.

5. Cleaning

- Mixing and application equipment should be cleaned immediately with mineral spirits. Remove hardened material mechanically. All solvents should be used only in accordance with manufacturer's recommendations. **Do not use solvents to clean hands or skin.**

Coverage

Coverage: approximately 125 ft²/gal (300 sqf/kit), actual will vary depending on the absorption and profile of the surface.

Storage

Silcor Primer EPS should be stored under cover, protected from moisture in original sealed containers above 40 °F (5 °C) and below 80 °F (25 °C) or crystallization may occur. Shelf life is 2 years in unopened containers stored under the conditions described above.

Health and Safety

Read the product label and SDS (Safety Data Sheet) before use. SDSs can be obtained from GCP Applied Technologies.

gcpat.com | For technical assistance call toll free: 1-866-333-3726

We hope the information here will be helpful. It is based on data and knowledge considered to be true and accurate, and is offered for consideration, investigation and verification by the user, but we do not warrant the results to be obtained. Please read all statements, recommendations, and suggestions in conjunction with our conditions of sale, which apply to all goods supplied by us. No statement, recommendation, or suggestion is intended for any use that would infringe any patent, copyright, or other third party right.

Silcor and Bituthene are trademarks, which may be registered in the United States and/or other countries, of GCP Applied Technologies Inc. This trademark list has been compiled using available published information as of the publication date and may not accurately reflect current trademark ownership or status.

© Copyright 2017 GCP Applied Technologies Inc. All rights reserved.

GCP Applied Technologies Inc., 62 Whittemore Avenue, Cambridge, MA 02140 USA.

In Canada, GCP Canada Inc., 294 Clements Road, West, Ajax, Ontario, Canada L1S 3C6.

GCP0083

SIL-004-0517



gcp applied technologies