

VYCOR® enV™
(SEE NOTE G)

GRACE VYCOR PLUS

PROTECT JOIST HANGERS
(SEE VCRDET-300)

SEAL TOP OF JOISTS
UNDER DECKING
(SEE VCRDET-301)

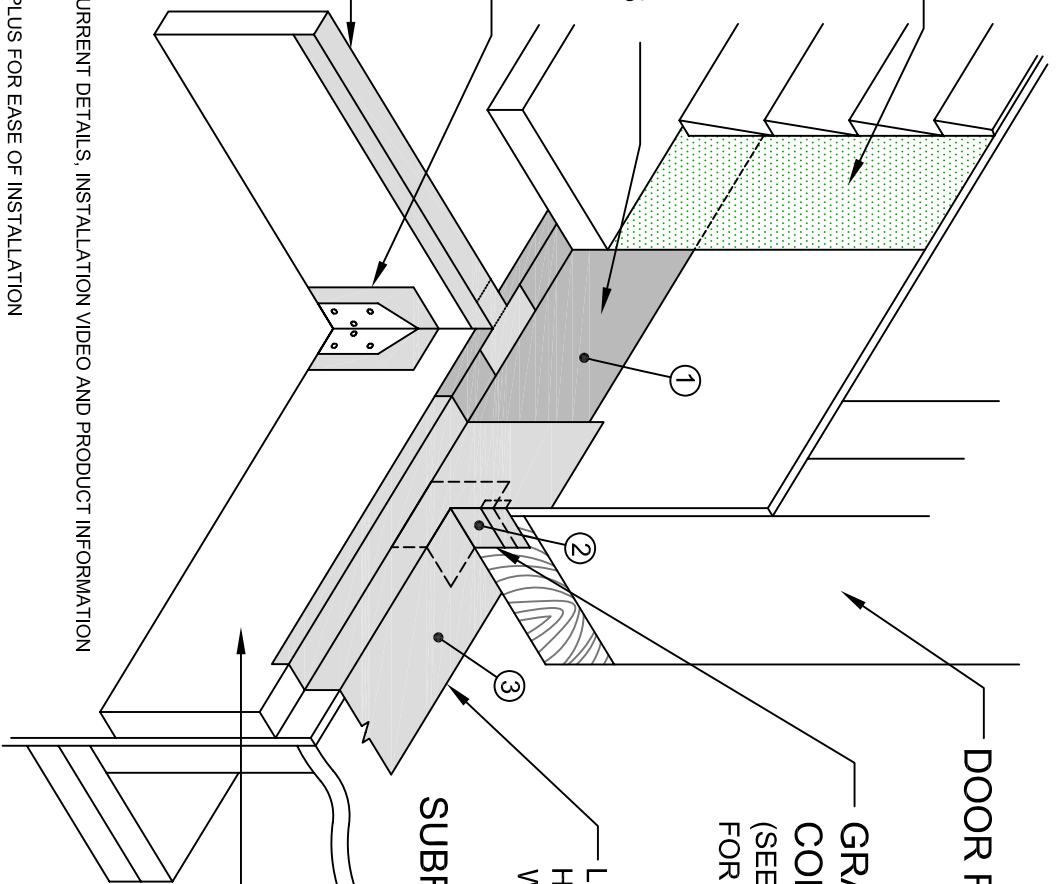

DOOR ROUGH OPENING

GRACE VYCORNER™ OR
CORNER PATCH RECOMMENDED
(SEE VCRDET-507 OR VCRDET-504
FOR OPTIONS)

LEAVE RELEASE PAPER ON LOWER
HALF OF SILL FLASHING UNTIL TIE-IN
WITH DECK FLASHING

SUBFLOOR

RIM JOIST

NOTES:

- A. VISIT GRACECONSTRUCTION.COM FOR THE MOST CURRENT DETAILS, INSTALLATION VIDEO AND PRODUCT INFORMATION SHEETS FOR FURTHER INFORMATION
- B. RIPCORD® CAN BE REMOVED FROM GRACE VYCOR PLUS FOR EASE OF INSTALLATION
- C. INSTALL GRACE VYCOR PLUS IN ORDER AS SHOWN BY NUMBERS
- D. INSTALL GRACE VYCOR PLUS AND VYCOR enV TO FORM WATER-SHEDDING LAPS
- E. INSTALL GRACE VYCOR PLUS AROUND REMAINING DOOR UNIT PER GRACE DETAILS (VCRDET-100 TO 103, 111 AND 200)
- F. DETAIL ALSO RELEVANT FOR ALL GRACE VYCOR FLASHINGS
- G. REFER TO LOCAL BUILDING CODE REQUIREMENTS FOR WEATHER RESISTIVE BARRIER

GRACE

Construction Products

www.graceconstruction.com

toll free 866-333-3726

EXTERIOR DOOR SILL CORNER

GRACE VYCOR® PLUS SELF-ADHERED FLASHING

Drawing: VCRDET-201

Scale: Not to scale

Effective Date: 04/01/09

Supersedes: 01/31/07