

PLAN VIEW

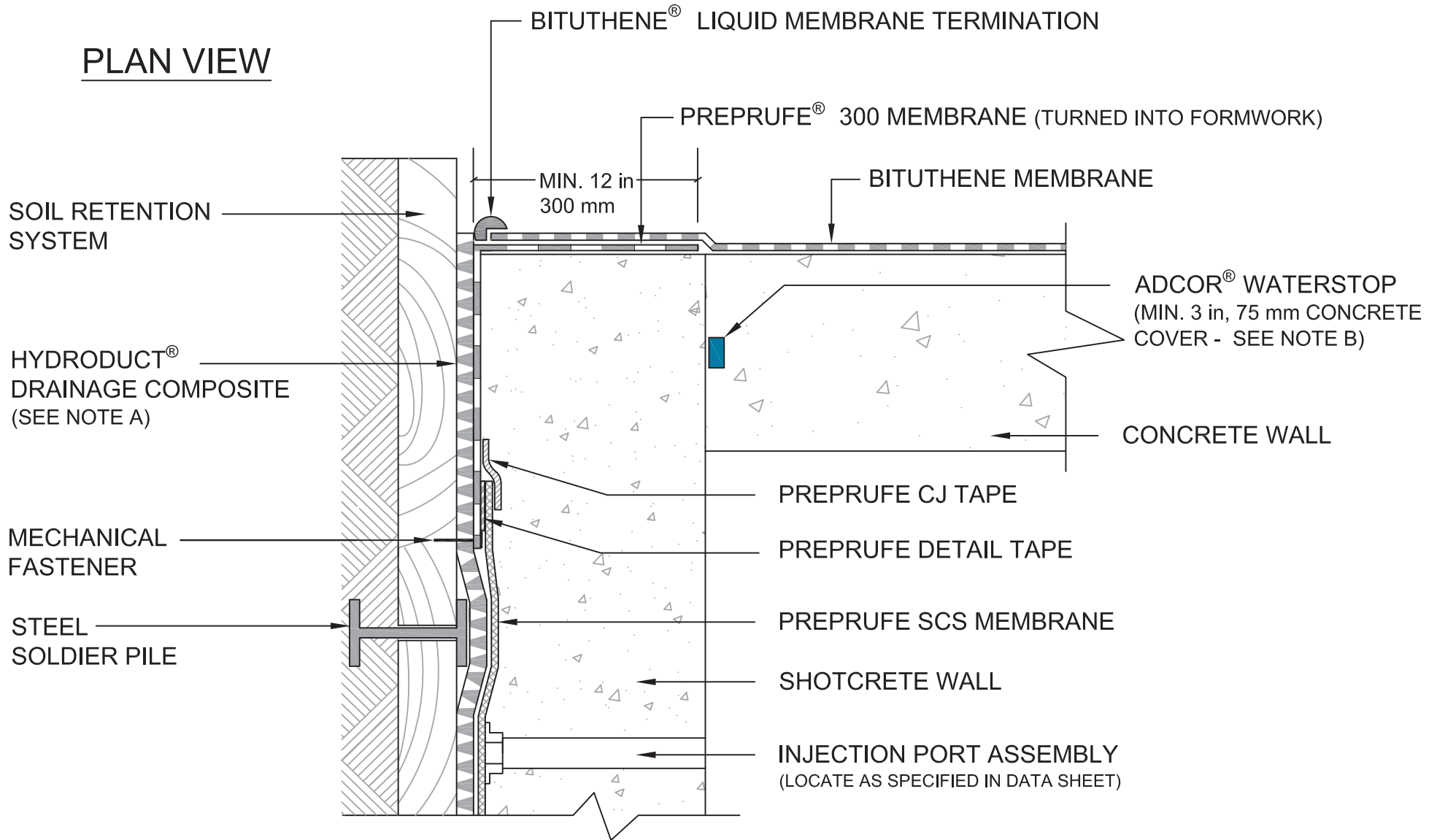

- NOTES: A) IF HYDRODUCT IS USED AS PART OF THE DRAINAGE SYSTEM, 6 MIL, 1.5 mm POLY IS REQUIRED BETWEEN THE HYDRODUCT AND THE PREPRUFE SCS MEMBRANE
 B) GCP MAY REQUIRE AN ALTERNATE GCP WATERSTOP BASED ON DESIGN CONDITIONS



**TIE-IN TO BITUTHENE® (WALL)
 PREPRUFE® SCS
 WATERPROOFING SYSTEM FOR SHOTCRETE**

DRAWING: SCS 006

SCALE: Not to scale

EFFECTIVE DATE: 08/01/2016

SUPERCEDES: 03172014