

Membrane de Liquide Bituthene®

Composé de détail élastomérique à application liquide à deux composants pour utilisation avec les membranes d'étanchéité de GCP

Product Description

Bituthene®Liquid Membrane is a two component, elastomeric, cold applied, trowel grade material designed for a variety of uses with the GCP waterproofing systems. The VOC (Volatile Organic Compound) content is 10 g/L. Architectural and industrial maintenance regulations limit the VOC content in products classified as architectural coatings. Refer to Technical Letters for the most current list of allowable limits.

Use

Bituthene®Liquid Membrane is ideally suited for the following uses:

- Fillet material at inside corners
- Reinforcement material at inside corners
- Flashing material around drains, protrusions, curbs and parapets
- Sealing material at terminations
- Repair material for defects on concrete surfaces
- Flashing material at corners

The two parts of Bituthene®Liquid Membrane are mixed on site and troweled on to provide a simple and quick waterproofing detailing aid in conjunction with Bituthene®, Preprufe®and Procor®systems.

Product Advantages

- Liquid applied
- Waterproof
- Tough, rubber-like
- Chemically cured
- Cold applied
- System compatible

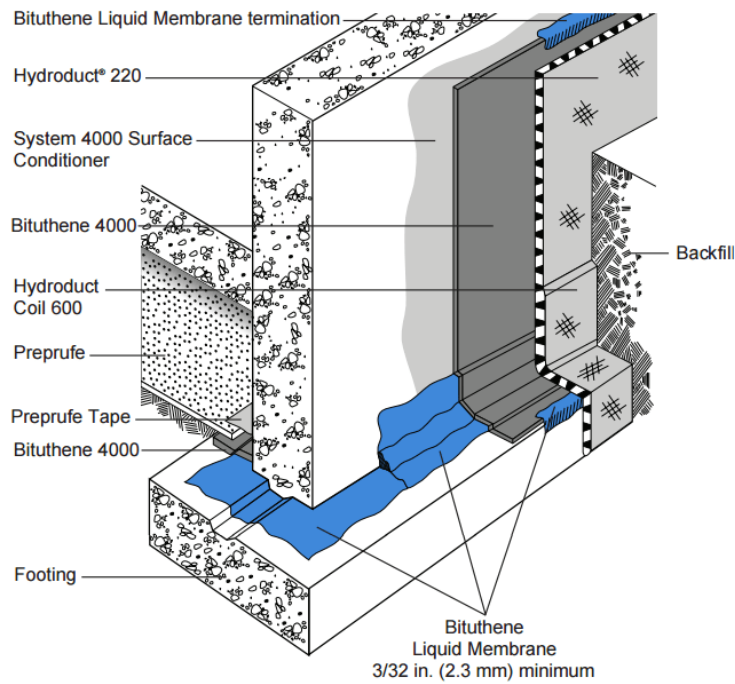

Supply

BITUTHENE® LIQUID MEMBRANE PROPERTY	PART A VALUE	PART B VALUE
Unit size	1.5 gal (5.7 L)	4 gal (15.1 L)
Net weight per unit	12.4 lbs (5.6 kg)	33 lbs (15 kg)
Units per pallet	100	24

Surface Preparation

All surfaces must be dry and free from dirt, grease, oil, dust or other contaminants. Bituthene®Liquid Membrane may be applied at temperatures of 25 °F (-4 °C) or above. Store in a dry place above 40 °F.

Mixing

Add the entire contents of the Part B container to Part A and mix for 3 to 5 minutes until uniform. Part A is black and Part B is clear. Take care to scrape material from the side and bottom of the containers to ensure thorough mixing. A low speed (150 rpm) mechanical mixer with flat paddle blades is required. Do not apply any material if streaks can be seen due to insufficient mixing. Once mixed, Bituthene®Liquid Membrane must be applied by trowel within 1.5 hours. More time is available at lower temperatures.

At high temperatures, thickening and curing will be faster. Material that has thickened must be discarded. The material will cure to a very flexible rubber-like material.

Bituthene®Liquid Membrane must be applied at a minimum thickness of 3/16 in. (2.3 mm) unless otherwise noted on details. In fillet applications, the face of the fillet should be a minimum of 3/4 in. (20 mm). In corner flashing application details, it should extend 6 in. (150 mm) in each direction from the corner. Bituthene®Liquid Membrane will adhere to primed or unprimed concrete.

Bituthene®Liquid Membrane should be allowed to cure at least 24 hours before flood testing.

Coverage

As a fillet material, 1 gal (3.8 L) will cover approximately 100 linear feet (30 m). As a flashing material, 1 gal (3.8 L) will cover approximately 17 f² (1.6 m²). As a fillet and reinforcement, 1 gal (3.8 L) will cover approximately 14 linear feet (4.3 m).

Cleaning

Clean tools and equipment with mineral spirits before Bituthene®Liquid Membrane has cured. Mineral spirits is a combustible liquid and should be used only in accordance with the manufacturer's safety recommendations. Do not use solvents to clean hands or skin.

Application Procedures

Safety, Storage and Handling Information

Bituthene®products must be handled properly. Vapors from solventbased primers and mastic are harmful and flammable. For these products, the best available information on safe handling, storage, personal protection, health and environmental considerations has been gathered. Safety Data Sheets (SDS) are available at gcpat.com and users should acquaint themselves with this information. Carefully read detailed precaution statements on product labels and the SDS before use.

Physical Properties

PROPERTY	TYPICAL VALUE	TEST METHOD
Part A Color	Black	
Part B Color	Clear	
Mixture of Parts A and B Color	Black	
Solids content	100%	ASTM D1644
Elongation	250% minimum	ASTM D412
Peel strength	5 lbs/in. (880 N/m) minimum	ASTM D903
Flexibility, 180° bend over 1 in. (25 mm) mandrel at -25°F (-32°C)	Unaffected	ASTM D1970

ca.gcpat.com | North America customer service: 1-877-4AD-MIX (1-877-423-6491)

Nous espérons que les renseignements ci-dessus s'avéreront utiles. Ces renseignements sont basés sur des données et des connaissances jugées véridiques et exactes. Ils sont soumis pour considération, étude et vérification, mais nous ne garantissons aucunement les résultats obtenus. Lire toutes les déclarations, recommandations, suggestions et conditions de vente relatives aux produits que nous fournissons. Aucune déclaration, recommandation ou suggestion ne doit être interprétée comme une incitation à commettre une contrefaçon de brevet quelconque.

Bituthene, Hydroduct et Preprufe sont des marques déposées qui peuvent être enregistrées aux États-Unis et dans d'autres pays, de GCP Applied Technologies Inc. Cette liste de marques a été établie à l'aide des informations publiées disponibles à la date de publication et peut ne pas refléter fidèlement la propriété ou le statut actuel de la marque.

© Copyright 2017 GCP Applied Technologies Inc. All rights reserved.

GCP Applied Technologies Inc., 62, avenue Whittemore, Cambridge, MA 02140, États-Unis.

Au Canada, GCP 294 Clements Road, West, Ajax, Ontario, Canada L1S 3C6.

This document is only current as of the last updated date stated below and is valid only for use in the Canada. It is important that you always refer to the currently available information at the URL below to provide the most current product information at the time of use. Additional literature such as Contractor Manuals, Technical Bulletins, Detail Drawings and detailing recommendations and other relevant documents are also available on www.gcpat.com. Information found on other websites must not be relied upon, as they may not be up-to-date or applicable to the conditions in your location and we do not accept any responsibility for their content. If there are any conflicts or if you need more information, please contact GCP Customer Service.

Last Updated: 2020-07-09

ca.gcpat.com/solutions/products/bituthene-post-applied-waterproofing-liquid-membrane